



IGNEOUS FIRE

IGNEOUS GROUP LTD



Our belief is to transform the way Fire Engineering is communicated. Fire Design is easy to understand when articulated in a simplest manner.”

Our why is to have a collaborative approach & consistent design. The way Fire Engineering is typically presented, either the relevant information is not captured or is buried in a plethora of generic text. This results in far too many avoidable issues during consent & construction causing delays & inconsistent information.

This is what Igneous Fire aims to avoid.

OUR TEAM



ABSAR AHMAD
FIRE ENGINEER | DIRECTOR
BE(Hons), MSc(Fire), MEngNZ, PMSFPE
E: absar.ahmad@igneousfire.co.nz
M: +64 22 347 3340



JEN TANG
FIRE ENGINEER | DIRECTOR
BE(Hons), MEngSt(Fire), CMEngNZ, CPEng, PMSFPE
E: jen.tang@igneousfire.co.nz
M: +64 22 347 3341



XU TAO
FIRE ENGINEER | CPEng
Msc (EE), MEngSt(Fire), CMEngNZ, CPEng, PMSFPE
E: xu.tao@igneousfire.co.nz
M: +64 22 347 3343

ABOUT US

Igneous fire is founded on the experience that more than often the fire design dictates & sets the requirements for other disciplines (alarm system, emergency lighting, surface finishes, occupancy limits). From concept through to building occupation, we provide forward-thinking approach to suit your design vision while establishing the fire safety elements for life safety, property protection & protection of firefighters.

We are here to revolutionise the way fire engineering is communicated. Lengthy fire reports, cluttered fire safety markups and rigid solutions limit design capabilities & makes information difficult to understand. **THIS IS NOT OUR APPROACH.**

We closely collaborate & coordinate with you & the design team along our journey. Together, we engineer smarter solutions yet simple-to-discern designs using our specialist expertise and our ability to adapting new technologies.

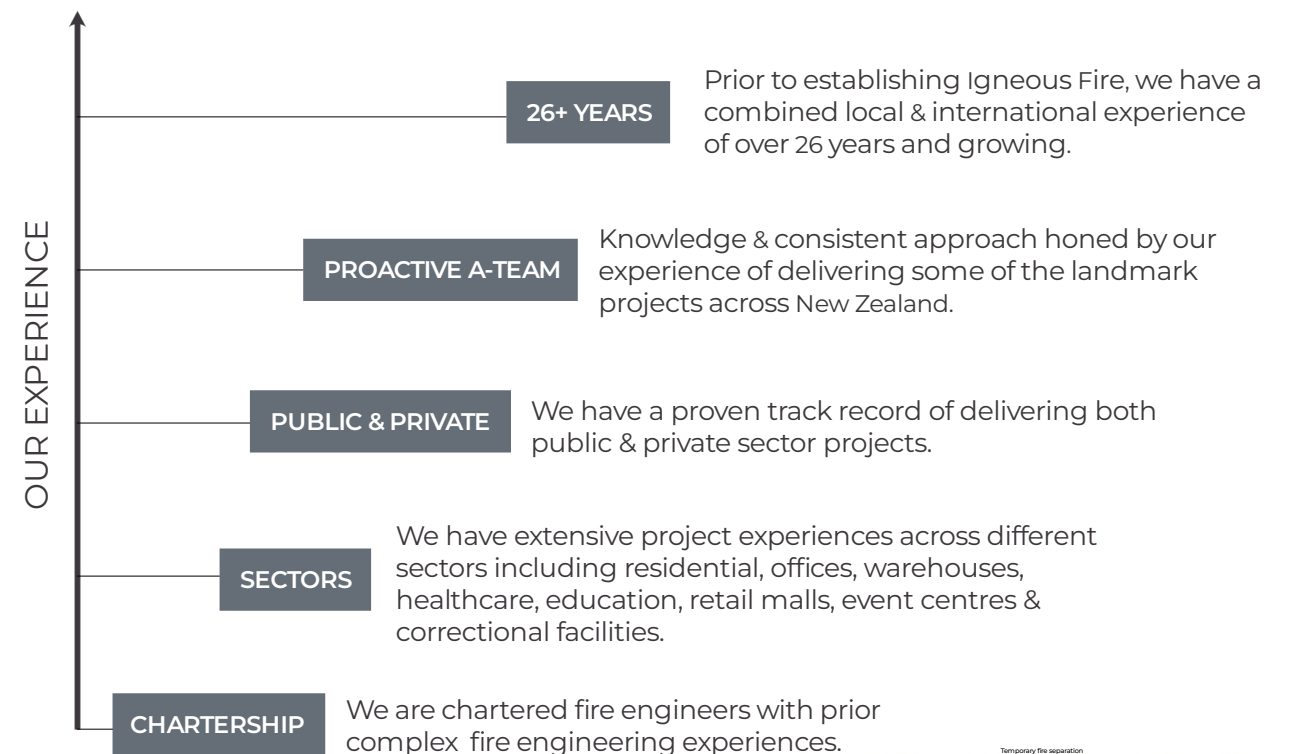

FITOUT FIRE SAFETY CAPABILITIES

Our ability does not only lie in completing bigger and often more complex base build designs. We understand how to approach fitout designs while understanding building code requirements as well as any base build limitations that could have potential implications on the alteration works.

We know from first principles of engineering to address key fire safety elements holistically at the earliest phase in the design, preventing issues during consent & construction rather than waiting for issues to arise.

Depictions here are examples of how we communicate the fire safety requirements in a concise manner and how this not only conveys the requirement to the design team but also makes it clear & easy to understand the scope for councils.

NOTE THAT THIS IS ONLY FOR REFERENCE.

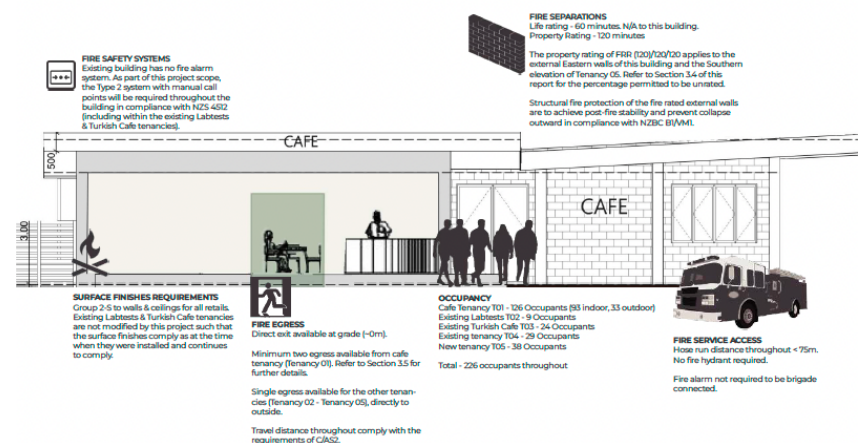

EXAMPLE OF OUR FIRE SAFETY COMMUNICATIONS ON OUR RECENT FITOUT PROJECT

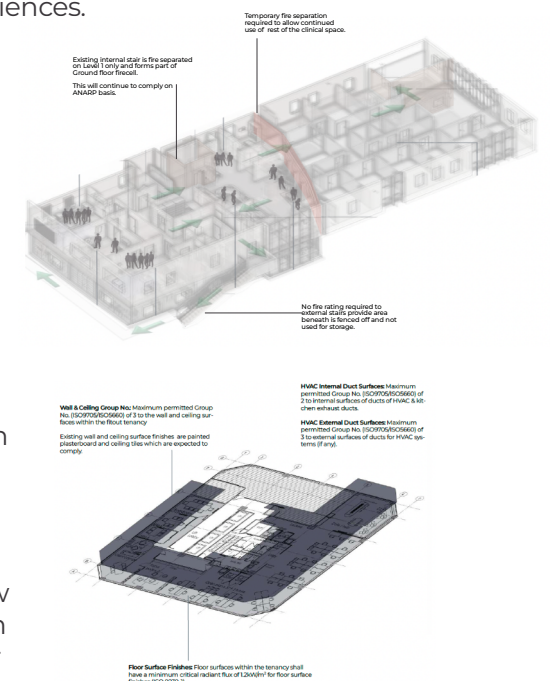

INTERESTED IN WORKING WITH US? CONTACT US TODAY!

E: info@igneousfire.co.nz
T: +64 9 391 3340